

drwg. no.:	1700
date:	-
model:	scale:
drw. rev.:	material:

# Type EP

Flame arrester for top of venting pipe

This drawing is for guidance only. Other sizes, materials, flange standards, settings, and versions are available. Request a specific quotation or approval drawing before implementing data.

16	400	770	436	545	515	16x25
14	350	635	360	505	460	16x22
12	300	635	360	445	400	12x22
10	250	540	395	395	350	12x22
8	200	465	360	340	295	8x22
7	175	410	320	315	270	8x22
6	150	370	310	285	240	8x22
4	100	320	250	220	180	8x18
3	80	230	120	200	160	4x18
2 1/2	65	230	120	185	145	4x18
2	50	230	120	165	125	4x18

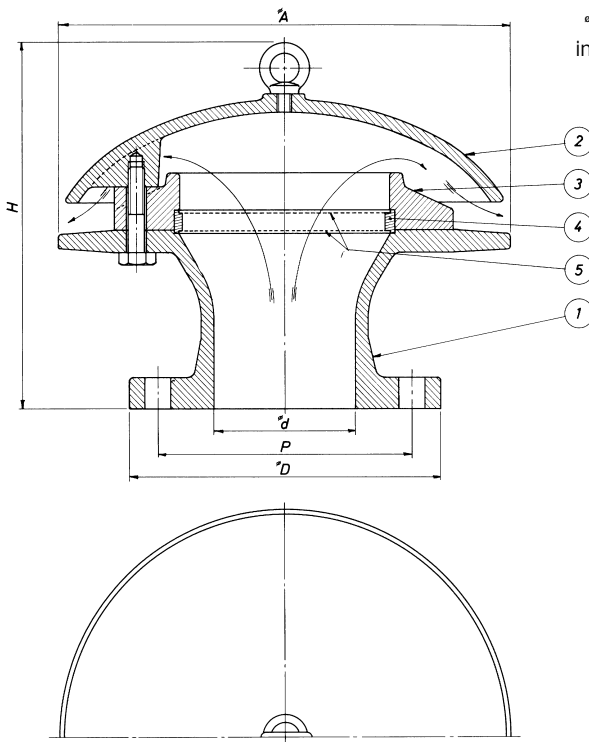

°D	°D	°A	H	°F	P-mm	Holes
inch	mm	mm	mm	mm	drilling	

Approved by:  
 Lloyds Register of Shipping  
 American bureau of Shipping  
 Det Norske Veritas  
 Bureau Veritas

### Parts list

Item	Description	Spec. 1	Spec. 2	Spec. 3
1	Housing	Cast iron		Bronze
2	Weather hood	Cast iron		Bronze
3	Deflector	Cast iron		Bronze
4	Net ring	Bronze		Bronze
5	Flame screen	Stainless steel		Bronze